

20070183776

OCTOBER 2006

0377-010

BAYHILL CLUBHOUSE AND MAINTENANCE AREA

SHEET 1 OF 2

158

DEDICATION: STATE OF FLORIDA

COUNTY OF PALM BEACH

KNOW ALL MEN BY THESE PRESENTS, WFGR ESTATES V. L.L.C., A DELAWARE LIMITED LIABILITY COMPANY, AND WFGR SERVICE V. L.L.C., A DELAWARE LIMITED LIABILITY COMPANY, OWNERS OF THE LAND SHOWN HEREON AS "BAYHILL CLUBHOUSE AND MAINTENANCE AREA" BEING A REPLAT OF ALL OF THE PLAT OF STONEWAL ESTATES P.U.D. PLAT NO. 5, RECORDED IN PLAT BOOK 89, PAGE 12, PUBLIC RECORDS, PALM BEACH COUNTY, FLORIDA AND BEING A PORTION OF SECTION 26, TOWNSHIP 42 SOUTH, RANGE 41 EAST, ALL LYING IN PALM BEACH COUNTY, FLORIDA, AND BEING MORE PARTICULARLY DESCRIBED AS FOLLOWS:

ALL OF THE PLAT OF STONEWAL ESTATES P.U.D. PLAT NO. 5, ACCORDING TO THE PLAT THEREOF AS RECORDED IN PLAT BOOK 89, PAGE 12, PUBLIC RECORDS, PALM BEACH COUNTY, FLORIDA.

TOGETHER WITH A PARCEL OF LAND LYING IN SECTION 26, TOWNSHIP 42 SOUTH, RANGE 41 EAST, PALM BEACH COUNTY, FLORIDA, BEING MORE PARTICULARLY DESCRIBED AS FOLLOWS:

BEGINNING AT THE NORTHEAST CORNER OF SAID PLAT, THENCE, NORTH 02°28'13" EAST, DEPARTING THE BOUNDARY OF SAID PLAT, A DISTANCE OF 160.00 FEET, THENCE, NORTH 87°33'47" WEST, ALONG A LINE 160.00 FEET NORTH OF, AS MEASURED AT RIGHT ANGLES TO, THE NORTH LINE OF SAID PLAT, A DISTANCE OF 415.40 FEET TO A POINT ON A CURVE CONCAVE WESTERLY HAVING A RADIUS OF 800.00 FEET AND WHOSE RADIUS POINT BEARS SOUTH 77°57'34" WEST; SAID POINT ALSO BEING A POINT ON THE EASTERLY RIGHT-OF-WAY LINE OF STONEWAL DRIVE (NOW BAYHILL DRIVE) AS RECORDED IN PLAT BOOK 47, PAGE 12, PUBLIC RECORDS, PALM BEACH COUNTY, FLORIDA; THENCE, SOUTHERLY ALONG SAID CURVE, AND ALONG SAID RIGHT-OF-WAY LINE, THROUGH A CENTRAL ANGLE OF 11°38'41", A DISTANCE OF 162.13 FEET TO THE NORTHWEST CORNER OF SAID PLAT; THENCE, SOUTH 87°33'47" EAST, DEPARTING SAID RIGHT-OF-WAY LINE AND ALONG THE NORTH LINE OF SAID PLAT, DISTANCE OF 391.00 FEET TO THE POINT OF BEGINNING.

CONTAINING: 9.47 ACRES, MORE OR LESS.

SUBJECT TO EASEMENTS, RESERVATIONS AND/OR RIGHTS-OF-WAY OF RECORD.

HAVE CAUSED THE SAME TO BE SURVEYED AND PLATTED AS SHOWN HEREON, AND DOES HEREBY MAKE THE FOLLOWING DEDICATIONS AND/OR RESERVATIONS:

- 1. TRACT "CH" (CLUBHOUSE PARCEL), AS SHOWN HEREON, IS HEREBY RESERVED FOR WFGR ESTATES V. L.L.C., A DELAWARE LIMITED LIABILITY COMPANY, ITS SUCCESSORS AND/OR ASSIGNS, FOR RECREATION PURPOSES AND IS THE PERPETUAL MAINTENANCE OBLIGATION OF SAID COMPANY, ITS SUCCESSORS AND/OR ASSIGNS, WITHOUT RECOURSE TO PALM BEACH COUNTY.
2. TRACT "M" (MAINTENANCE PARCEL), AS SHOWN HEREON, IS HEREBY RESERVED FOR WFGR SERVICE V. L.L.C., A DELAWARE LIMITED LIABILITY COMPANY, ITS SUCCESSORS AND/OR ASSIGNS, FOR MAINTENANCE PURPOSES AND IS THE PERPETUAL MAINTENANCE OBLIGATION OF SAID COMPANY, ITS SUCCESSORS AND/OR ASSIGNS, WITHOUT RECOURSE TO PALM BEACH COUNTY.
3. TRACT "ER", AS SHOWN HEREON, IS HEREBY RESERVED FOR WFGR ESTATES V. L.L.C., A DELAWARE LIMITED LIABILITY COMPANY, ITS SUCCESSORS AND/OR ASSIGNS, FOR ALL PROPER LEGAL AND LAWFUL PURPOSES AND IS THE PERPETUAL MAINTENANCE OBLIGATION OF SAID COMPANY, ITS SUCCESSORS AND/OR ASSIGNS, WITHOUT RECOURSE TO PALM BEACH COUNTY.
4. UTILITY EASEMENTS, AS SHOWN HEREON, ARE NON-EXCLUSIVE EASEMENTS AND ARE HEREBY DEDICATED IN PERPETUITY TO THE PUBLIC FOR THE INSTALLATION, OPERATION, MAINTENANCE, REPAIR, EXPANSION AND REPLACEMENT OF UTILITIES, BOTH PUBLIC AND PRIVATE, INCLUDING, BUT NOT LIMITED TO POTABLE WATER PIPELINES, RAW WATER PIPELINES, WASTEWATER PIPELINES, RECLAIMED WATER PIPELINES, ELECTRIC POWER LINES, TELECOMMUNICATION LINES, CABLE TELEVISION LINES, GAS LINES, AND RELATED APPURTENANCES, NO BUILDINGS, STRUCTURES, IMPROVEMENTS, TREES, WALLS OR FENCES SHALL BE INSTALLED WITHIN THESE EASEMENTS WITHOUT THE PRIOR WRITTEN APPROVAL OF INDIAN TRAIL IMPROVEMENT DISTRICT, ITS SUCCESSORS AND ASSIGNS.
5. BUFFER EASEMENTS WITHIN TRACT "M", AS SHOWN HEREON, ARE HEREBY RESERVED FOR WFGR SERVICE V. L.L.C., A DELAWARE LIMITED LIABILITY COMPANY, ITS SUCCESSORS AND ASSIGNS, FOR BUFFER PURPOSES AND ARE THE PERPETUAL MAINTENANCE OBLIGATION OF SAID COMPANY, ITS SUCCESSORS AND/OR ASSIGNS.
6. BUFFER EASEMENTS WITHIN TRACTS "CH" AND "ER", AS SHOWN HEREON, ARE HEREBY RESERVED FOR WFGR ESTATES V. L.L.C., A DELAWARE LIMITED LIABILITY COMPANY, ITS SUCCESSORS AND ASSIGNS, FOR BUFFER PURPOSES AND ARE THE PERPETUAL MAINTENANCE OBLIGATION OF SAID COMPANY, ITS SUCCESSORS AND/OR ASSIGNS.
7. FIVE FOOT LIMITED ACCESS EASEMENTS (I.A.E.), AS SHOWN HEREON, ARE HEREBY DEDICATED TO THE BOARD OF COUNTY COMMISSIONERS OF PALM BEACH COUNTY, FLORIDA, FOR THE PURPOSE OF CONTROL AND JURISDICTION OVER ACCESS RIGHTS.

IN WITNESS WHEREOF, WFGR ESTATES V. L.L.C., A DELAWARE LIMITED LIABILITY COMPANY, LICENSED TO DO BUSINESS IN FLORIDA, BY: WSC MANAGERS V. INC., A DELAWARE CORPORATION, THE SOLE GENERAL PARTNER OF WALTON STREET MANAGERS V. L.P., A DELAWARE LIMITED PARTNERSHIP, WHICH LIMITED PARTNERSHIP IS THE SOLE GENERAL PARTNER OF WALTON STREET REAL ESTATE FUND V. L.P., A DELAWARE LIMITED PARTNERSHIP, WHICH LIMITED PARTNERSHIP IS THE SOLE MANAGING MEMBER OF WALTON ACQUISITION REOC HOLDINGS V. L.L.C., A DELAWARE LIMITED LIABILITY COMPANY, WHICH LIMITED LIABILITY COMPANY IS THE SOLE MEMBER OF WALTON FLORIDA GOLF RESORT HOLDINGS V. L.L.C., A DELAWARE LIMITED LIABILITY COMPANY, WHICH LIMITED LIABILITY COMPANY IS THE MANAGING MEMBER OF WALTON FLORIDA GOLF RESORT INVESTORS V. L.L.C., A DELAWARE LIMITED LIABILITY COMPANY, WHICH LIMITED LIABILITY COMPANY IS THE SOLE MEMBER OF WFGR ESTATES MEZZ V. L.L.C., A DELAWARE LIMITED LIABILITY COMPANY, WHICH LIMITED LIABILITY COMPANY IS THE SOLE MEMBER OF SAID WFGR ESTATES V. L.L.C., A DELAWARE LIMITED LIABILITY COMPANY, AND THE CORPORATE SEAL OF SAID WSC MANAGERS V. INC., A DELAWARE CORPORATION, TO BE AFFIXED HERETO BY AND WITH THE AUTHORITY OF ITS BOARD OF DIRECTORS THIS 28TH DAY OF DECEMBER, 2006.

WFGR ESTATES V. L.L.C.

A DELAWARE LIMITED LIABILITY COMPANY, LICENSED TO DO BUSINESS IN FLORIDA

BY: WFGR ESTATES MEZZ V. L.L.C., A DELAWARE LIMITED LIABILITY COMPANY, ITS SOLE MEMBER
BY: WALTON FLORIDA GOLF RESORT INVESTORS V. L.L.C., A DELAWARE LIMITED LIABILITY COMPANY, ITS SOLE MEMBER
BY: WALTON FLORIDA GOLF RESORT HOLDINGS V. L.L.C., A DELAWARE LIMITED LIABILITY COMPANY, ITS MANAGING MEMBER
BY: WALTON ACQUISITION REOC HOLDINGS V. L.L.C., A DELAWARE LIMITED LIABILITY COMPANY, ITS SOLE MEMBER
BY: WALTON STREET REAL ESTATE FUND V. L.P., A DELAWARE LIMITED PARTNERSHIP, ITS MANAGING MEMBER
BY: WALTON STREET MANAGERS V. L.P., A DELAWARE LIMITED PARTNERSHIP, ITS GENERAL PARTNER
BY: WSC MANAGERS V. INC., A DELAWARE CORPORATION, ITS GENERAL PARTNER

WITNESS: Michelle Mezey, Justin Leonard
VICE PRESIDENT
VICE PRESIDENT
PRINT NAME: MICHELLE MEZEY
WITNESS: Laura Kennedy
PRINT NAME: LAURA KENNEDY

ACKNOWLEDGMENT:

STATE OF FLORIDA

COUNTY OF PALM BEACH

BEFORE ME PERSONALLY APPEARED JUSTIN LEONARD, WHO (IS) (IS NOT) PERSONALLY KNOWN TO ME AND (HAS) (HAS NOT) PRODUCED AS IDENTIFICATION, AND (DID) (DID NOT) TAKE AN OATH, AND WHO EXECUTED THE FOREGOING INSTRUMENT AS THE VICE PRESIDENT OF WSC MANAGERS V. INC., A DELAWARE CORPORATION, THE SOLE GENERAL PARTNER OF WALTON STREET MANAGERS V. L.P., A DELAWARE LIMITED PARTNERSHIP, WHICH LIMITED PARTNERSHIP IS THE SOLE GENERAL PARTNER OF WALTON STREET REAL ESTATE FUND V. L.P., A DELAWARE LIMITED PARTNERSHIP, WHICH LIMITED PARTNERSHIP IS THE SOLE MANAGING MEMBER OF WALTON ACQUISITION REOC HOLDINGS V. L.L.C., A DELAWARE LIMITED LIABILITY COMPANY, WHICH LIMITED LIABILITY COMPANY IS THE SOLE MEMBER OF WALTON FLORIDA GOLF RESORT HOLDINGS V. L.L.C., A DELAWARE LIMITED LIABILITY COMPANY, WHICH LIMITED LIABILITY COMPANY IS THE MANAGING MEMBER OF WALTON FLORIDA GOLF RESORT INVESTORS V. L.L.C., A DELAWARE LIMITED LIABILITY COMPANY, WHICH LIMITED LIABILITY COMPANY IS THE SOLE MEMBER OF WFGR ESTATES MEZZ V. L.L.C., A DELAWARE LIMITED LIABILITY COMPANY, WHICH LIMITED LIABILITY COMPANY IS THE SOLE MEMBER OF SAID WFGR ESTATES V. L.L.C., A DELAWARE LIMITED LIABILITY COMPANY, AND HE ACKNOWLEDGED TO AND BEFORE ME THAT HE EXECUTED SUCH INSTRUMENT AS SUCH OFFICER OF SAID CORPORATION, AND THAT THE SEAL AFFIXED TO THE FOREGOING INSTRUMENT IS THE CORPORATE SEAL OF SAID CORPORATION AND THAT IT WAS AFFIXED TO SAID INSTRUMENT BY DUE AND REGULAR CORPORATE AUTHORITY, AND THAT SAID INSTRUMENT IS THE FREE ACT AND DEED OF SAID CORPORATION.

WITNESS MY HAND AND OFFICIAL SEAL THIS 28TH DAY OF DECEMBER, 2006.

MY COMMISSION EXPIRES: 09/03/09 NOTARY PUBLIC: Niore Koussé SEAL:
PRINTED NAME: Niore Koussé COMMISSION NO. 633572

IN WITNESS WHEREOF, WFGR SERVICE V. L.L.C., A DELAWARE LIMITED LIABILITY COMPANY, LICENSED TO DO BUSINESS IN FLORIDA, BY: WSC MANAGERS V. INC., A DELAWARE CORPORATION, THE SOLE GENERAL PARTNER OF WALTON STREET MANAGERS V. L.P., A DELAWARE LIMITED PARTNERSHIP, WHICH LIMITED PARTNERSHIP IS THE SOLE GENERAL PARTNER OF WALTON STREET REAL ESTATE FUND V. L.P., A DELAWARE LIMITED PARTNERSHIP, WHICH LIMITED PARTNERSHIP IS THE SOLE MANAGING MEMBER OF WALTON ACQUISITION REOC HOLDINGS V. L.L.C., A DELAWARE LIMITED LIABILITY COMPANY, WHICH LIMITED LIABILITY COMPANY IS THE SOLE MEMBER OF WALTON FLORIDA GOLF RESORT HOLDINGS V. L.L.C., A DELAWARE LIMITED LIABILITY COMPANY, WHICH LIMITED LIABILITY COMPANY IS THE MANAGING MEMBER OF WALTON FLORIDA GOLF RESORT INVESTORS V. L.L.C., A DELAWARE LIMITED LIABILITY COMPANY, WHICH LIMITED LIABILITY COMPANY IS THE SOLE MEMBER OF WFGR ESTATES MEZZ V. L.L.C., A DELAWARE LIMITED LIABILITY COMPANY, WHICH LIMITED LIABILITY COMPANY IS THE SOLE MEMBER OF SAID WFGR SERVICE V. L.L.C., A DELAWARE LIMITED LIABILITY COMPANY, AND THE CORPORATE SEAL OF SAID WSC MANAGERS V. INC., A DELAWARE CORPORATION, TO BE AFFIXED HERETO BY AND WITH THE AUTHORITY OF ITS BOARD OF DIRECTORS THIS 28TH DAY OF DECEMBER, 2006.

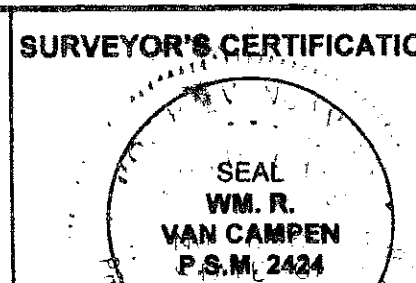

SURVEYOR'S CERTIFICATION: I HEREBY CERTIFY THAT THE PLAT SHOWN HEREON IS A TRUE AND CORRECT REPRESENTATION OF A SURVEY MADE UNDER MY RESPONSIBLE DIRECTION AND SUPERVISION, THAT SAID SURVEY IS ACCURATE TO THE BEST OF MY KNOWLEDGE AND BELIEF; THAT PERMANENT REFERENCE MONUMENTS (P.R.M.'S) HAVE BEEN PLACED AS REQUIRED BY LAW, AND THAT MONUMENTS ACCORDING TO SECTION 177.091(9), FLORIDA STATUTES, HAVE BEEN PLACED AS REQUIRED BY LAW, AND FURTHER, THAT THE SURVEY DATA COMPLIES WITH ALL THE REQUIREMENTS OF CHAPTER 177, FLORIDA STATUTES, AS AMENDED, AND ORDINANCES OF THE COUNTY OF PALM BEACH, FLORIDA.
BY: Wm. R. Van Campen DATED THIS 11TH DAY OF OCTOBER, 2006.
WM. R. VAN CAMPEN, P.S.M. 2424
ASSOCIATED LAND SURVEYORS, INC., 4152 W. BLUE HERON BLVD., SUITE 121, RIVIERA BEACH, FLORIDA, L.B. 7344

NOTICE: THIS PLAT AS RECORDED IN ITS GRAPHIC FORM, IS THE OFFICIAL DEPICTION OF THE SUBDIVIDED LANDS DESCRIBED HEREIN AND WILL IN NO CIRCUMSTANCES BE SUPPLANTED IN AUTHORITY BY ANY OTHER GRAPHIC OR DIGITAL FORM OF THE PLAT. THERE MAY BE ADDITIONAL RESTRICTIONS THAT ARE NOT RECORDED ON THIS PLAT THAT MAY BE FOUND IN THE PUBLIC RECORDS OF THIS COUNTY.
THIS INSTRUMENT WAS PREPARED BY WM. R. VAN CAMPEN, P.S.M. 2424 IN AND FOR THE OFFICES OF ASSOCIATED LAND SURVEYORS, INC., 4152 WEST BLUE HERON BOULEVARD, SUITE 121, RIVIERA BEACH, FLORIDA.

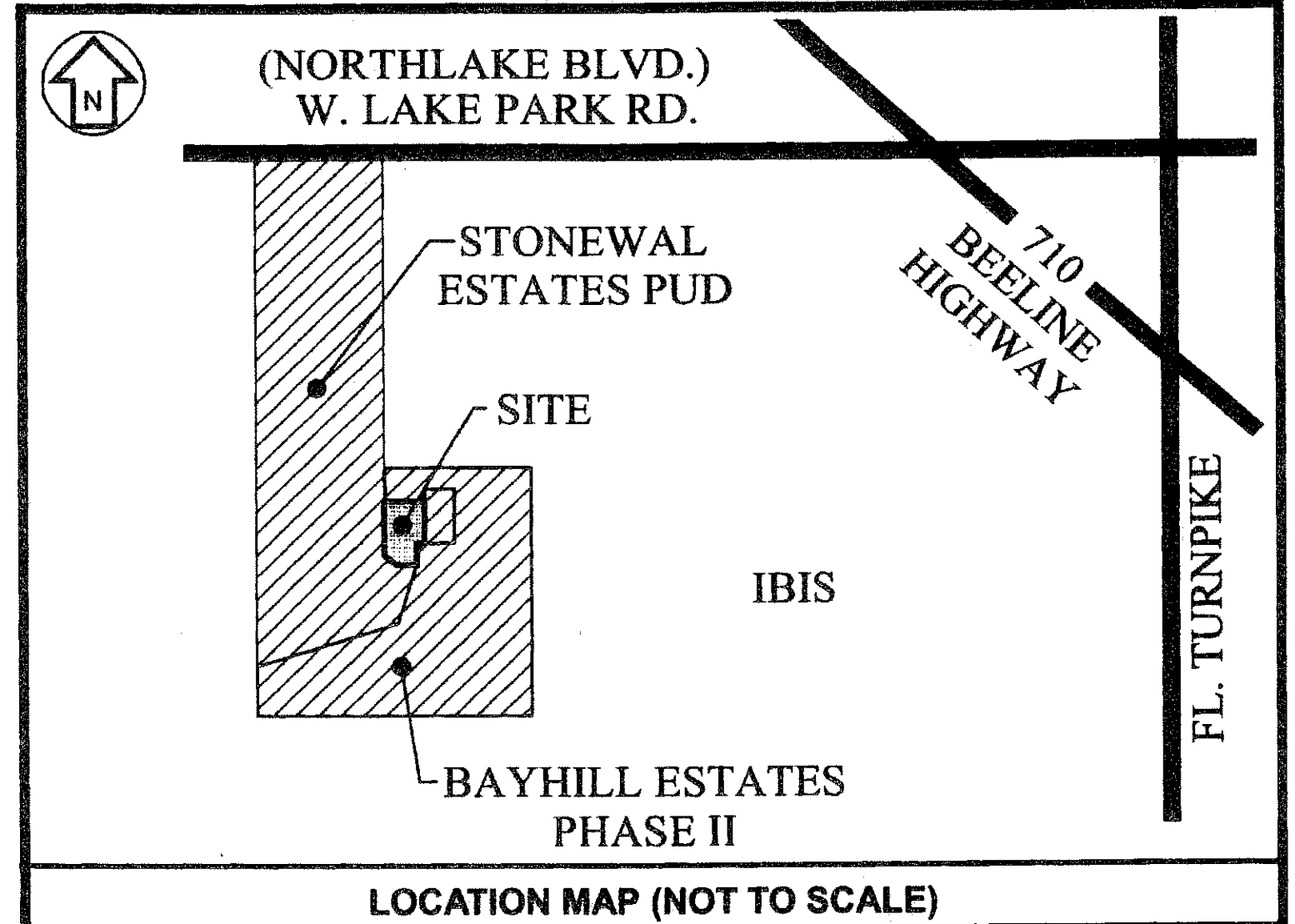

WFGR SERVICE V. L.L.C.

A DELAWARE LIMITED LIABILITY COMPANY, LICENSED TO DO BUSINESS IN FLORIDA

BY: WFGR SERVICE MEZZ V. L.L.C., A DELAWARE LIMITED LIABILITY COMPANY, ITS SOLE MEMBER
BY: WALTON FLORIDA GOLF RESORT INVESTORS V. L.L.C., A DELAWARE LIMITED LIABILITY COMPANY, ITS SOLE MEMBER
BY: WALTON FLORIDA GOLF RESORT HOLDINGS V. L.L.C., A DELAWARE LIMITED LIABILITY COMPANY, ITS MANAGING MEMBER
BY: WALTON ACQUISITION REOC HOLDINGS V. L.L.C., A DELAWARE LIMITED LIABILITY COMPANY, ITS SOLE MEMBER
BY: WALTON STREET REAL ESTATE FUND V. L.P., A DELAWARE LIMITED PARTNERSHIP, ITS MANAGING MEMBER
BY: WALTON STREET MANAGERS V. L.P., A DELAWARE LIMITED PARTNERSHIP, ITS GENERAL PARTNER
BY: WSC MANAGERS V. INC., A DELAWARE CORPORATION, ITS GENERAL PARTNER

WITNESS: Michelle Mezey, Justin Leonard
VICE PRESIDENT
VICE PRESIDENT
PRINT NAME: MICHELLE MEZEY
WITNESS: Laura Kennedy
PRINT NAME: LAURA KENNEDY

ACKNOWLEDGMENT:

STATE OF FLORIDA

COUNTY OF PALM BEACH

BEFORE ME PERSONALLY APPEARED JUSTIN LEONARD, WHO (IS) (IS NOT) PERSONALLY KNOWN TO ME AND (HAS) (HAS NOT) PRODUCED AS IDENTIFICATION, AND (DID) (DID NOT) TAKE AN OATH, AND WHO EXECUTED THE FOREGOING INSTRUMENT AS THE VICE PRESIDENT OF WSC MANAGERS V. INC., A DELAWARE CORPORATION, THE SOLE GENERAL PARTNER OF WALTON STREET MANAGERS V. L.P., A DELAWARE LIMITED PARTNERSHIP, WHICH LIMITED PARTNERSHIP IS THE SOLE GENERAL PARTNER OF WALTON STREET REAL ESTATE FUND V. L.P., A DELAWARE LIMITED PARTNERSHIP, WHICH LIMITED PARTNERSHIP IS THE SOLE MANAGING MEMBER OF WALTON ACQUISITION REOC HOLDINGS V. L.L.C., A DELAWARE LIMITED LIABILITY COMPANY, WHICH LIMITED LIABILITY COMPANY IS THE SOLE MEMBER OF WALTON FLORIDA GOLF RESORT HOLDINGS V. L.L.C., A DELAWARE LIMITED LIABILITY COMPANY, WHICH LIMITED LIABILITY COMPANY IS THE MANAGING MEMBER OF WALTON FLORIDA GOLF RESORT INVESTORS V. L.L.C., A DELAWARE LIMITED LIABILITY COMPANY, WHICH LIMITED LIABILITY COMPANY IS THE SOLE MEMBER OF WFGR SERVICE MEZZ V. L.L.C., A DELAWARE LIMITED LIABILITY COMPANY, WHICH LIMITED LIABILITY COMPANY IS THE SOLE MEMBER OF SAID WFGR SERVICE V. L.L.C., A DELAWARE LIMITED LIABILITY COMPANY, AND HE ACKNOWLEDGED TO AND BEFORE ME THAT HE EXECUTED SUCH INSTRUMENT AS SUCH OFFICER OF SAID CORPORATION, AND THAT THE SEAL AFFIXED TO THE FOREGOING INSTRUMENT IS THE CORPORATE SEAL OF SAID CORPORATION AND THAT IT WAS AFFIXED TO SAID INSTRUMENT BY DUE AND REGULAR CORPORATE AUTHORITY, AND THAT SAID INSTRUMENT IS THE FREE ACT AND DEED OF SAID CORPORATION.

WITNESS MY HAND AND OFFICIAL SEAL THIS 28TH DAY OF DECEMBER, 2006.
MY COMMISSION EXPIRES: 09/03/09 NOTARY PUBLIC: Niore Koussé SEAL:
PRINTED NAME: Niore Koussé COMMISSION NO. 633572

MORTGAGEE'S CONSENT:

STATE OF FLORIDA

COUNTY OF PALM BEACH

THE UNDERSIGNED, HEREBY CERTIFIES THAT IT IS THE HOLDER OF A MORTGAGE UPON THE PROPERTY DESCRIBED HEREON, AND DOES HEREBY JOIN IN AND CONSENT TO THE DEDICATION OF THE LAND DESCRIBED IN SAID DEDICATION BY THE OWNER THEREOF AND AGREES THAT ITS MORTGAGE WHICH IS RECORDED IN OFFICIAL RECORDS BOOK 20741, PAGE 281, PUBLIC RECORDS, PALM BEACH COUNTY, FLORIDA, SHALL BE SUBORDINATED TO THE DEDICATION SHOWN HEREON.

GREENWICH CAPITAL FINANCIAL PRODUCTS, INC. MANAGING DIRECTOR

IN WITNESS WHEREOF, THE SAID CORPORATION HAS CAUSED THESE PRESENTS TO BE SIGNED BY ITS SENIOR VICE PRESIDENT AND ATTESTED BY ITS SENIOR VICE PRESIDENT, AND ITS CORPORATE SEAL TO BE AFFIXED HERETO BY AND WITH THE AUTHORITY OF ITS BOARD OF DIRECTORS THIS 28TH DAY OF DECEMBER, 2006.

WITNESS: John Burke
MANAGING DIRECTOR
PRINTED NAME: JOHN BURKE

ACKNOWLEDGMENT:

STATE OF FLORIDA

COUNTY OF PALM BEACH

BEFORE ME PERSONALLY APPEARED JOHN BURKE, WHO (IS) (IS NOT) PERSONALLY KNOWN TO ME OR HAVE PRODUCED AS IDENTIFICATION, AND WHO EXECUTED THE FOREGOING INSTRUMENT AS MANAGING DIRECTOR OF GREENWICH CAPITAL FINANCIAL PRODUCTS, INC., AND SEVERALLY ACKNOWLEDGED TO AND BEFORE ME THAT HE EXECUTED SUCH INSTRUMENT AS OFFICER OF SUCH CORPORATION AND THAT THE SEAL AFFIXED TO THE FOREGOING INSTRUMENT IS THE CORPORATE SEAL OF SAID CORPORATION AND THAT IT WAS AFFIXED TO SAID INSTRUMENT BY DUE AND REGULAR CORPORATE AUTHORITY, AND THAT SAID INSTRUMENT IS THE FREE ACT AND DEED OF SAID CORPORATION.

WITNESS MY HAND AND OFFICIAL SEAL THIS 28TH DAY OF DECEMBER, 2006.
MY COMMISSION EXPIRES: 01/12/2010 NOTARY PUBLIC: Lisa L. Mezyk SEAL:
PRINTED NAME: LISA L. MEZYK COMMISSION NO. N/A

PETITION NUMBER: 83-018

AREA SUMMARY

TRACT "CH".....6.65 ACRES
TRACT "M".....1.47 ACRES
TRACT "ER".....1.35 ACRES
TOTAL AREA = 9.47 ACRES

GENERAL EASEMENT NOTES & RESTRICTIVE COVENANTS:

- 1. BUILDING SETBACKS SHALL CONFORM TO THE PALM BEACH COUNTY, FLORIDA, ZONING CODE.
2. NO BUILDINGS OR ANY KIND OF CONSTRUCTION OR TREES OR SHRUBS SHALL BE PLACED ON ANY EASEMENT WITHOUT PRIOR WRITTEN APPROVAL OF ALL EASEMENT BENEFICIARIES AND ALL APPLICABLE PALM BEACH COUNTY APPROVALS OR PERMITS AS REQUIRED FOR SUCH ENCROACHMENTS.

COORDINATE, DISTANCE AND BEARING NOTES:

- 1. THE COORDINATES SHOWN HEREON ARE STATE PLANE GRID COORDINATES ACCORDING TO THE TRANSVERSE MERCATOR PROJECTION OF THE FLORIDA EAST ZONE, N.A.D. 83, PER THE 1990 ADJUSTMENT.
2. THE BEARING BASE (BB), AS SHOWN HEREON, IS BASED ON THE STATE PLANE GRID AZIMUTH BEARING OF NORTH 02°28'13" EAST, ALONG THE WEST LINE OF STONEWAL ESTATES P.U.D. PLAT NO. 5.
3. THE LINEAR DIMENSIONS SHOWN HEREON ARE GROUND DISTANCES IN U.S. FEET AND DECIMAL PARTS THEREOF.
4. THE GROUND DISTANCE TO GRID DISTANCE SCALE FACTOR IS 1.00015 (GROUND DISTANCE X SCALE FACTOR = GRID DISTANCE).

INDIAN TRAIL IMPROVEMENT DISTRICT ACCEPTANCE:

STATE OF FLORIDA
COUNTY OF PALM BEACH
INDIAN TRAIL IMPROVEMENT DISTRICT HEREBY ACCEPTS THE NON-EXCLUSIVE EASEMENTS, AS SHOWN HEREON, AND HEREBY ACKNOWLEDGES THAT SAID DISTRICT HAS NO MAINTENANCE OBLIGATIONS ON OR UNDER THE LANDS OVER WHICH SAID EASEMENTS LIE, AND FURTHER ACKNOWLEDGES THAT THERE ARE NO OTHER MAINTENANCE OBLIGATIONS, OR DEDICATIONS TO, BEING INCURRED BY SAID DISTRICT ON THIS PLAT.

DATED THIS 7th DAY OF February, 2007
INDIAN TRAIL IMPROVEMENT DISTRICT
ATTEST: MIKE ERICKSON, VICE PRESIDENT BOARD OF DIRECTORS
BY: MICHELLE DAMONE, PRESIDENT BOARD OF DIRECTORS

ACKNOWLEDGMENT:

STATE OF FLORIDA

COUNTY OF PALM BEACH

BEFORE ME PERSONALLY APPEARED MICHELLE DAMONE AND ERICKSON, WHO ARE PERSONALLY KNOWN TO ME AND WHO EXECUTED THE FOREGOING AS PRESIDENT AND VICE PRESIDENT, RESPECTIVELY, OF THE BOARD OF DIRECTORS OF INDIAN TRAIL IMPROVEMENT DISTRICT, AND SEVERALLY ACKNOWLEDGED TO AND BEFORE ME THAT THEY EXECUTED SUCH INSTRUMENT AS SUCH OFFICERS OF SAID DISTRICT BOARD, AND THAT THE SEAL AFFIXED TO THE FOREGOING INSTRUMENT IS THE DISTRICT SEAL OF SAID DISTRICT AND THAT IT WAS AFFIXED TO SAID INSTRUMENT BY DUE AND REGULAR DISTRICT AUTHORITY, AND THAT SAID INSTRUMENT IS THE FREE ACT AND DEED OF SAID DISTRICT.
WITNESS MY HAND AND OFFICIAL SEAL THIS 7th DAY OF February, 2007.
MY COMMISSION EXPIRES August 1, 2010 BY: Robert T. Mearens NOTARY PUBLIC
PRINTED NAME: Robert T. Mearens COMMISSION NO. DD580454

TITLE CERTIFICATION:

STATE OF FLORIDA

COUNTY OF PALM BEACH

I, H. WILLIAM WALKER, JR., A DULY LICENSED ATTORNEY IN THE STATE OF FLORIDA, DO HEREBY CERTIFY THAT I HAVE EXAMINED THE TITLE TO THE HEREON DESCRIBED PROPERTY, THAT I FIND THE TITLE TO THE PROPERTY IS VESTED IN WFGR ESTATES V. L.L.C., A DELAWARE LIMITED LIABILITY COMPANY AND VESTED IN WFGR SERVICE V. L.L.C., A DELAWARE LIMITED LIABILITY COMPANY; THAT THE CURRENT TAXES HAVE BEEN PAID; THAT ALL MORTGAGES NOT SATISFIED OR RELEASED OF RECORD NOR OTHERWISE TERMINATED BY LAW ARE SHOWN HEREON; AND THAT THERE ARE ENCUMBRANCES OF RECORD, BUT THOSE ENCUMBRANCES DO NOT PROHIBIT THE CREATION OF THE SUBDIVISION CREATED BY THIS PLAT.
DATE: January 3, 2007 BY: H. WILLIAM WALKER, JR., ATTORNEY-AT-LAW LICENSED IN FLORIDA

PALM BEACH COUNTY APPROVAL:

COUNTY ENGINEER OF PALM BEACH COUNTY
THIS PLAT IS HEREBY APPROVED FOR RECORD PURSUANT TO PALM BEACH COUNTY ORDINANCE 95-33 AND IN ACCORDANCE WITH SECTION 177.071(2), F.S., THIS 16 DAY OF April, A.D. 2007 AND HAS BEEN REVIEWED BY A PROFESSIONAL SURVEYOR AND MAPPER EMPLOYED BY PALM BEACH COUNTY IN ACCORDANCE WITH SECTION 177.081(1), F.S.
BY: George T. Webb, P.E. COUNTY ENGINEER



ASSOCIATED LAND SURVEYORS, INC.
4152 W. BLUE HERON BLVD.- SUITE 121
RIVIERA BEACH, FLORIDA 33404
PHONE: (561)848-2102 FAX: (561)844-9659 L.B. NO. 7344

RECORD PLAT
BAYHILL CLUBHOUSE AND MAINTENANCE AREA

SEPARATION Bayhill Clubhouse & Maint Area
BOOK 158
PAGE 15B
RECORD DATE
ZONING RE
QUALITY
SS
L.B. 636
PUB NUMBER